

Modular Drawer



THE ROUSSEAU DRAWER: FIRST TO THE FINISH LINE

The sturdiest and the most durable on the market

Tested in an independent laboratory, the Rousseau drawer proved its superiority on many levels: loaded to its full capacity, the Rousseau drawer completed a high level of cycles, without showing any signs of wear. The Rousseau drawer has become the champion of its category.

Its performance can be defined in terms of its durability. The Rousseau drawer's sturdy construction offers superior output while having a much longer lifespan. This is why Rousseau doesn't even hesitate to offer a Lifetime Warranty on the drawer rolling mechanism. An undeniable advantage!

A multitude of accessories

The Rousseau drawer makes your work easy: the vast array of accessories offered, all of which are compatible with each other, contribute to maximizing the organization of your work space. In addition, all of these accessories can be easily rearranged according to your needs, making them a joy to use and displaying just how highly functional they are.

Streamlined design

In addition to being sturdy and functional, the Rousseau drawer has an alluring appearance. It fits just as well in an office as it does in a factory. It allows you to arrange your work space in a harmonious and aesthetic fashion. The unique shape of the "R" drawer is a Rousseau Metal Inc. trademark and we have protected the industrial design of the drawer.



The Rousseau drawer rolling mechanism is covered by a lifetime warranty.

Modular Drawer

The Rousseau Advantages



With a capacity of 400 lb., the drawer can be opened thousands of times without showing signs of slowing down.



10 drawer heights and 8 side heights are available.

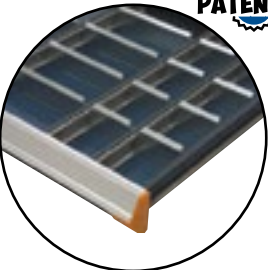

Partitions and dividers are clipped in.

PATENTED



Company name embossed on the face of the drawer. If you don't see ROUSSEAU, it's not a ROUSSEAU.

INDUSTRIAL DESIGN PATENTED

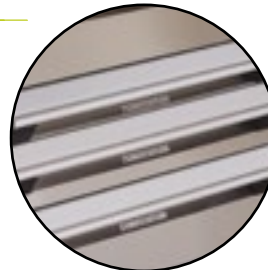

Stainless steel drawer front brings a polished look to cabinets and shelving. Excellent chemical and corrosion resistance.

Details that make the difference

ERGONOMIC

The full-width handle as well as the accessories (Integrated Lock-In mechanism, Lock-Out mechanism, lock, etc.) have been designed down to the smallest detail in order to make your work easier.

EFFICIENT

A multitude of available accessories, such as partitions and dividers, plastic bins, groove trays, foam for tools and hanging file bars allow you to organize your space.

ACCESSIBLE

Drawers open 100%, giving you complete access to the contents.

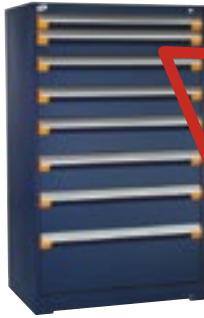

R5AEE-5825

STURDY

400 lb. capacity per drawer.



DURABLE

NOTE The unique shape of the "R" drawer is a Rousseau Metal Inc. trademark.



R5SEE-874803

INGENIOUS

Accessories can be added at all times.

22 drawer sizes x 10 heights = 220 possible dimensions

18" W

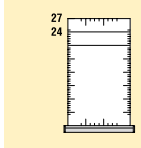

24" W

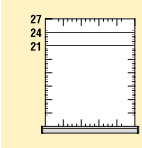

30" W

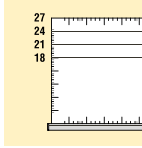

36" W

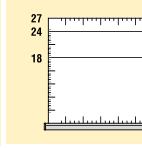

42" W

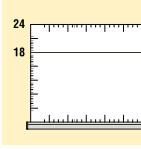

48" W

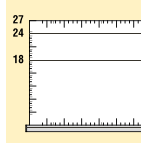

54" W

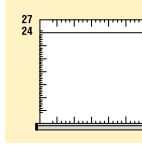

60" W

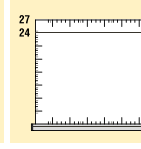

Index	Page(s)
Modular Drawer	162 - 167
Proposals	168 - 184
Accessories	185 - 189

Modular Drawer

Modular Drawers and Roll-Out Shelves

Heavy-Duty Modular Drawer



Painted steel drawer for cabinets (and multi-drawer) : RF31;
 Painted steel drawer for shelving : RF32;
 Drawer with stainless steel front and gray-painted interior for cabinets (and multi-drawer) : RF35;
 Drawer with stainless steel front and gray-painted interior for shelving : RF36;
 400 lb capacity, 100% extension;
 Heavy-duty construction;
 Easy to install;
 Vast choice of accessories offered to adapt to your storage needs;
 Available drawer heights : 3", 4", 5", 6", 7", 8", 9", 10", 12" and 14";
 Order by adding the drawer height to the product # and by specifying the type of application (cabinet or shelving) and the type of drawer front (painted steel or stainless steel). Ex.: RF31-362406.
 For modular drawers with layouts.

SEE PAGES 186-189

SEE PAGES 168-185

Product #	W x D
RF_-2421	24" x 21"
RF_-2424	24" x 24"
RF_-2427	24" x 27"
RF_-3018	30" x 18"
RF_-3021	30" x 21"
RF_-3024	30" x 24"
RF_-3027	30" x 27"
RF_-3618	36" x 18"
RF_-3624	36" x 24"
RF_-3627	36" x 27"
RF_-4218	42" x 18"
RF_-4224	42" x 24"
RF_-4818	48" x 18"
RF_-4824	48" x 24"
RF_-4827	48" x 27"
RF_-5424	54" x 24"
RF_-5427	54" x 27"
RF_-6024	60" x 24"
RF_-6027	60" x 27"

Heavy-Duty Front Access Roll-Out Shelf



Roll-out shelf for cabinet (and multi-drawer) : RF40;
 Roll-out shelf for shelving : RF41;
 400 lb capacity, 100% extension;
 Heavy-duty construction;
 Easy to install;
 Painted steel with 3" edges on sides and back;
 Height : 6";
 Full access to contents;
 Order by specifying the type of application (cabinet or shelving). Ex.: RF40-3624.

Heavy-Duty 3 Sided Access Roll-Out Shelf



Roll-out shelf, 3-sided access for cabinet (and multi-drawer) : RF44;
 Roll-out shelf, 3-sided access for shelving : RF45;
 400 lb capacity, 100% extension;
 Heavy-duty construction;
 Easy to install;
 Galvanized steel with 1 1/2" edge on back;
 Height : 5";
 May serve as work surface;
 Order by specifying the type of application (cabinet or shelving). Ex.: RF44-3624.

Product #	W x D
RF_-2421	24" x 21"
RF_-2424	24" x 24"
RF_-2427	24" x 27"
RF_-3018	30" x 18"
RF_-3021	30" x 21"
RF_-3024	30" x 24"
RF_-3027	30" x 27"
RF_-3618	36" x 18"
RF_-3624	36" x 24"
RF_-3627	36" x 27"
RF_-4218	42" x 18"
RF_-4224	42" x 24"
RF_-4818	48" x 18"
RF_-4824	48" x 24"
RF_-4827	48" x 27"
RF_-5424	54" x 24"
RF_-5427	54" x 27"
RF_-6024	60" x 24"
RF_-6027	60" x 27"



Modular Drawer

Drawer and Roll-Out Shelf Dimensions

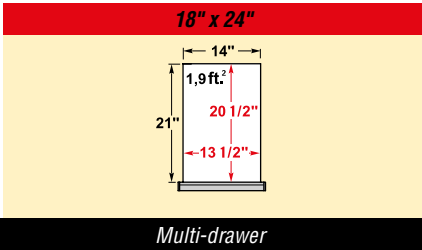
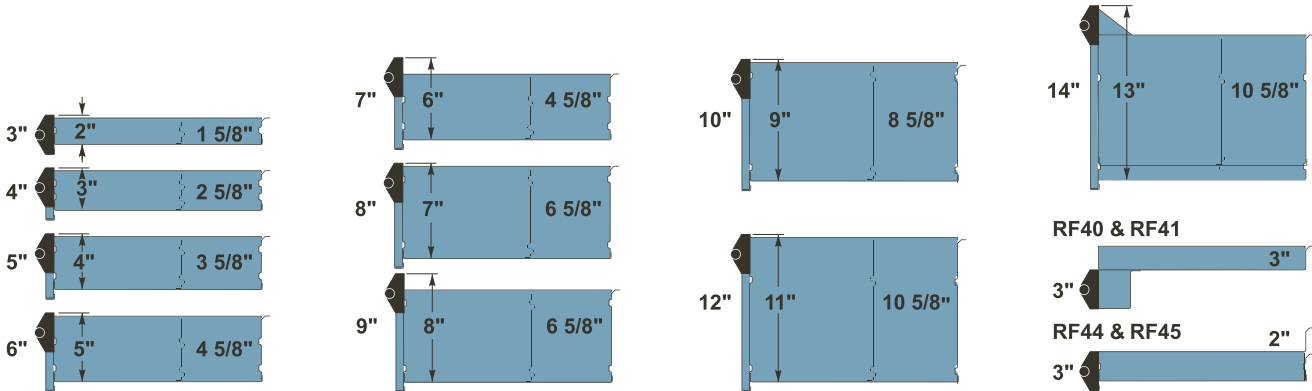

SEE PAGES 58-65

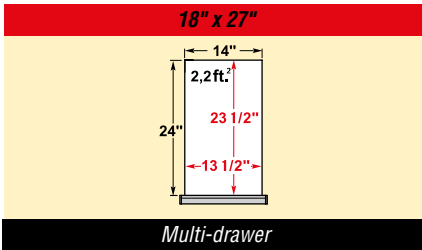

SEE PAGES 58-65

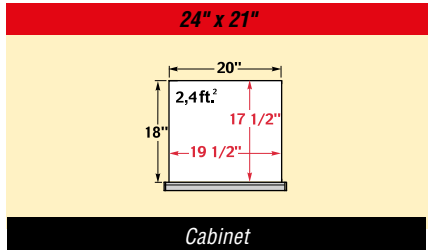

RF31-2421 ___
RF35-2421 ___
RF40-2421 ___
RF44-2421 ___

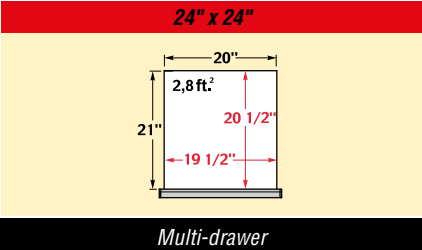

SEE PAGES 58-65

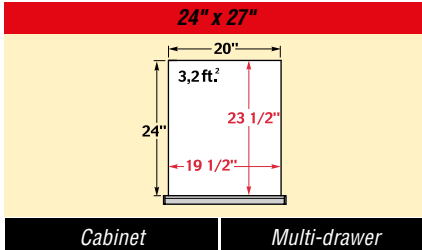

RF31-2427 ___
RF35-2427 ___
RF40-2427 ___
RF44-2427 ___

SEE PAGES 58-65

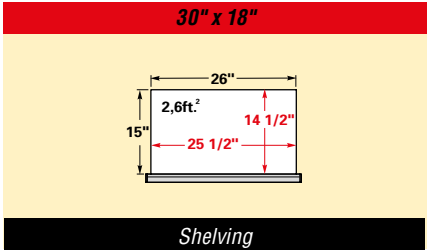

RF32-3018 ___
RF36-3018 ___
RF41-3018 ___
RF45-3018 ___

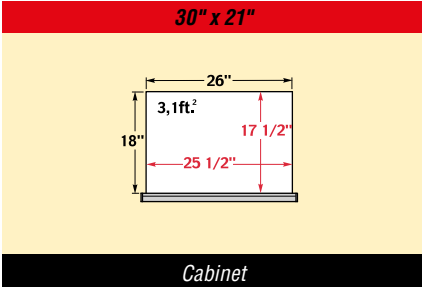

RF31-3021 ___
RF35-3021 ___
RF40-3021 ___
RF44-3021 ___

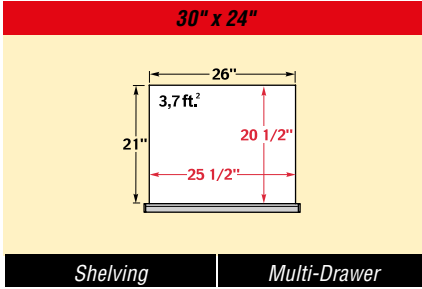

RF32-3024 ___
RF36-3024 ___
RF41-3024 ___
RF45-3024 ___

SEE PAGES 58-65

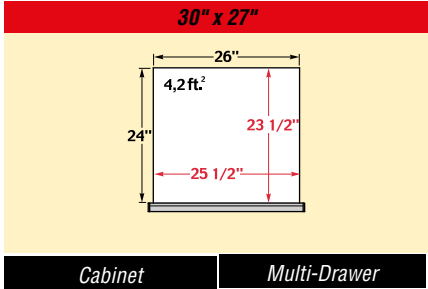

RF31-3027 ___
RF35-3027 ___
RF40-3027 ___
RF44-3027 ___

SEE PAGES 58-65

Modular Drawer



36" x 27"

Shelving	Multi-Drawer
RF31-3627	
RF35-3627	
RF40-3627	
RF44-3627	

48" x 18"

Shelving
RF32-4818
RF36-4818
RF41-4818
RF45-4818



R5EKG-5808

36" x 18"

Cabinet	Shelving
RF31-3618	RF32-3618
RF35-3618	RF36-3618
RF40-3618	RF41-3618
RF44-3618	RF45-3618

42" x 18"

Shelving
RF32-4218
RF36-4218
RF41-4218
RF45-4218

48" x 24"

Cabinet	Shelving	Multi-Drawer
RF31-4824	RF32-4824	
RF35-4824	RF36-4824	
RF40-4824	RF41-4824	
RF44-4824	RF45-4824	

54" x 24"

Cabinet	Multi-Drawer
RF31-5424	
RF35-5424	
RF40-5424	
RF44-5424	

60" x 24"

Cabinet	Multi-Drawer
RF31-6024	
RF35-6024	
RF40-6024	
RF44-6024	

36" x 24"

Cabinet	Shelving	Multi-Drawer
RF31-3624	RF32-3624	
RF35-3624	RF36-3624	
RF40-3624	RF41-3624	
RF44-3624	RF45-3624	

42" x 24"

Shelving
RF32-4224
RF36-4224
RF41-4224
RF45-4224

48" x 27"

Cabinet	Multi-Drawer
RF31-4827	
RF35-4827	
RF40-4827	
RF44-4827	

54" x 27"

Cabinet	Multi-Drawer
RF31-5427	
RF35-5427	
RF40-5427	
RF44-5427	

60" x 27"

Cabinet	Multi-Drawer
RF31-6027	
RF35-6027	
RF40-6027	
RF44-6027	

How to Order a Drawer

You can choose a drawer model from among our proposals with layouts :

- 00** for layout kit only
- 51** for a painted steel drawer in a cabinet, with layout
- 52** for a painted steel drawer in shelving, with layout,

SEE PAGES 168-185

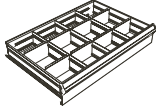

EXAMPLE: R EE-A0200

Drawer height: SEE PAGE 165

Locking or security mechanism: SEE PAGE 189

Example : R52EE-A020006L3A
for a drawer (36" W x 24" D) in shelving, with layout, 6" drawer height with lock on drawer and integrated Lock-in mechanism.

You can create a personalized model by choosing an empty drawer (to which you can add layout accessories) :

- 31** for a painted steel drawer in a cabinet
- 32** for a painted steel drawer in shelving
- 35** for a drawer with stainless steel front in a cabinet
- 36** for a drawer with stainless steel front in shelving

EXAMPLE: RF 31-3624

Drawer height: SEE PAGE 165

Locking or security mechanism: SEE PAGE 189

Example : RF31-362406L3A
for a painted steel drawer (36" W x 24" D) for cabinet, 6" drawer height with lock on the drawer and integrated Lock-in mechanism.

To add layout accessories, accessories must be ordered separately

SEE PAGES 186-189

To calculate drawer compartment dimensions, refer to the following illustration.

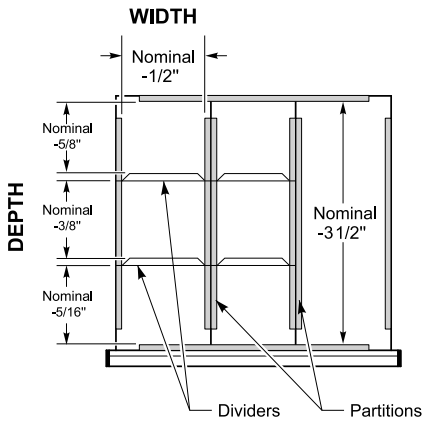

Drawer dimensions

		INSIDE WIDTH							
		14"	20"	26"	32"	38"	44"	50"	56"
OUTSIDE DEPTH	27"								
	24"	18"x27"	24"x27"	30"x27"	36"x27"				
	21"	18"x24"	24"x24"	30"x24"	36"x24"	42"x24"	48"x24"	54"x24"	60"x24"
INSIDE DEPTH	18"	18"x21"	24"x21"	30"x21"					
	15"				36"x18"	42"x18"	48"x18"		
		OUTSIDE WIDTH							
		18"	24"	30"	36"	42"	48"	54"	60"

How to Order a Roll-Out Shelf

Complete the first portion of the # according to the type of roll-out shelf being ordered :

- 40** for a roll-out shelf in a cabinet
- 41** for a roll-out shelf in shelving
- 44** for roll-out shelf with 3-sided access for cabinet
- 45** for roll-out shelf with 3-sided access for shelving

EXAMPLE: RF 41-3624

Locking or security mechanism: SEE PAGE 189

Complete Example : RF41-3624A
for a roll-out shelf with 3-sided access for a cabinet, with integrated Lock-In mechanism.



R5XEE-2002

Proposals

To order, complete the part number with the drawer height :

- 00** for compartments only
- 51** for a painted steel drawer in a cabinet, with layout
- 52** for a painted steel drawer in shelving, with layout

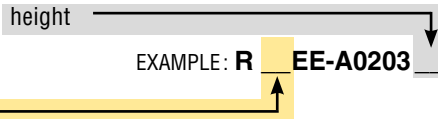

Ex.: R51CD-A010206
for a painted steel drawer with compartments for a 24" W x 21" D cabinet, 6" high.

18" x 24" (W x D) Drawer For Multi-Drawer

Partitions and Dividers

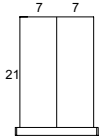

R00BE-A0100
2 compartments

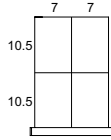

R00BE-A0102
4 compartments

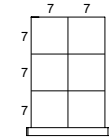

R00BE-A0104
6 compartments

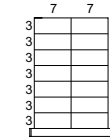

R00BE-A0112
14 compartments

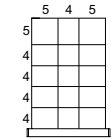

R00BE-A0212
15 compartments

Plastic Bins

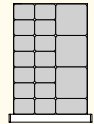

R00BE-E018
18 bins

Groove Trays

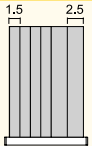

R00BE-G00603
6 groove trays

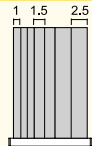

R00BE-G00703
7 groove trays

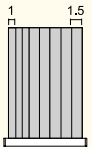

R00BE-G00803
8 groove trays
2 dividers included with each groove tray.

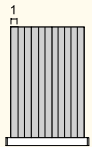

R00BE-G01103
11 groove trays

Foam

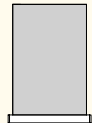

R00BE-J0103
For protection

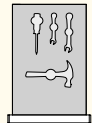

R00BE-J0203
For tools

Sold without cut-outs

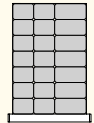

R00BE-E021
21 bins

Folder Hanging Bars

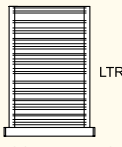

R00BE-KFB12

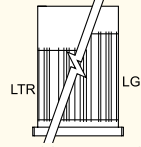

R00BE-KLR12

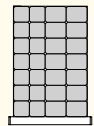
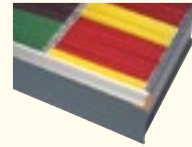

R00BE-E028
28 bins

18" x 27" (W x D) Drawers For Multi-Drawer

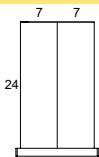

R00BG-A0100
2 compartments

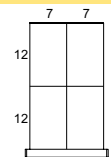

R00BG-A0102
4 compartments

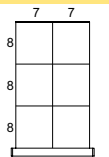

R00BG-A0104
6 compartments

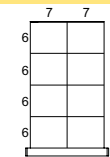

R00BG-A0106
8 compartments

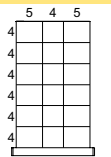

R00BG-A0215
18 compartments

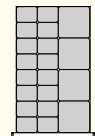

R00BG-E020
20 bins

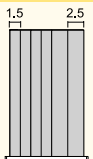

R00BG-G00603
6 groove trays

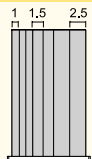

R00BG-G00703
7 groove trays

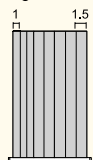

R00BG-G00803
8 groove trays

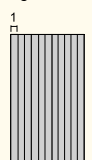

R00BG-G01103
11 groove trays

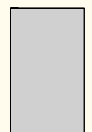

R00BG-J0103
For protection

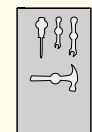

R00BG-J0203
For tools

Sold without cut-outs

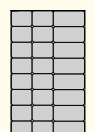

R00BG-E024
24 bins

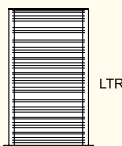

R00BG-KFB12

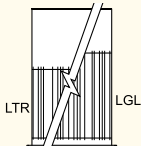

R00BG-KLR12

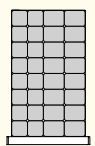
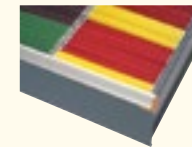

R00BG-E032
32 bins

24" x 21" (W x D) Drawers

For Cabinet

Partitions and Dividers

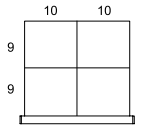

R_CD-A0102
4 compartments

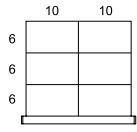

R_CD-A0104
6 compartments

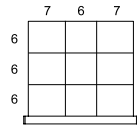

R_CD-A0206
9 compartments

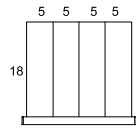

R_CD-A0300
4 compartments

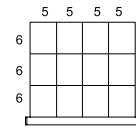

R_CD-A0308
12 compartments

Plastic Bins

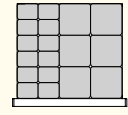

R_CD-E018
18 bins

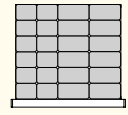

R_CD-E024
24 bins

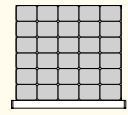

R_CD-E030
30 bins

Groove Trays

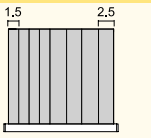

R_CD-G00803
8 groove trays

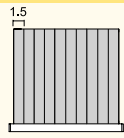

R_CD-G01003
10 groove trays

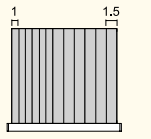

R_CD-G01203
12 groove trays

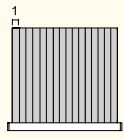

R_CD-G01603
16 groove trays

2 dividers included with each groove tray.

Foam

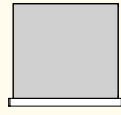

R_CD-J0103
For protection

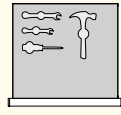

R_CD-J0203
For tools



Sold without cut-outs

Folder Hanging Bars

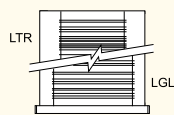

R_CD-KFB12

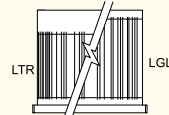

R_CD-KLR12

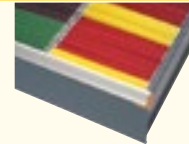

24" x 24" (W x D) Drawers

For Multi-Drawer

Partitions and Dividers

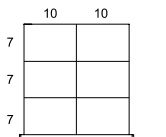

ROOCE-A0104
6 compartments

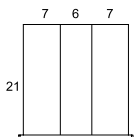

ROOCE-A0200
3 compartments

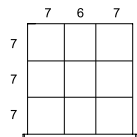

ROOCE-A0206
9 compartments

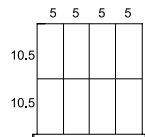

ROOCE-A0304
8 compartments

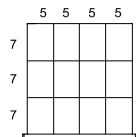

ROOCE-A0308
12 compartments

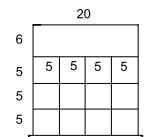

ROOCE-C0408
13 compartments

Plastic Bins

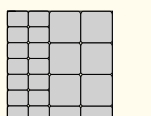

ROOCE-E022
22 bins

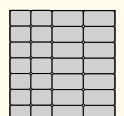

ROOCE-E028
28 bins

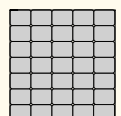

ROOCE-E035
35 bins

Groove Trays

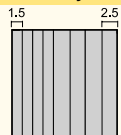

ROOCE-G00803
8 groove trays

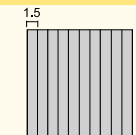

ROOCE-G01003
10 groove trays

2 dividers included with each groove tray.

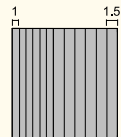

ROOCE-G01203
12 groove trays

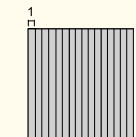

ROOCE-G01603
16 groove trays

Folder Hanging Bars

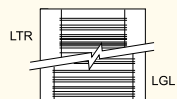

ROOCE-KFB12

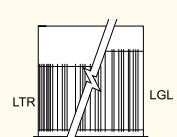

ROOCE-KLR12

Foam



ROOCE-J0103
For protection

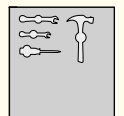

ROOCE-J0203
For tools



Sold without cut-outs

Proposals

24" x 27" (W x D) Drawers

For Cabinet

For Multi-Drawer

Partitions and Dividers

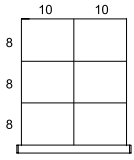

R_CG-A0104
6 compartments

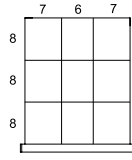

R_CG-A0206
9 compartments

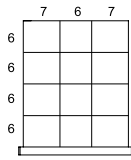

R_CG-A0209
12 compartments

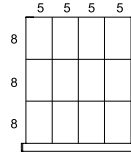

R_CG-A0308
12 compartments

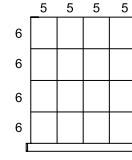

R_CG-A0312
16 compartments

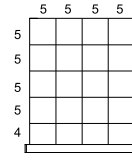

R_CG-A0316
20 compartments

Plastic Bins

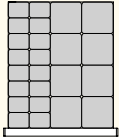

R_CG-E024
24 bins

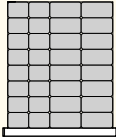

R_CG-E032
32 bins

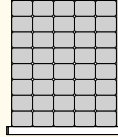

R_CG-E040
40 bins

Foam

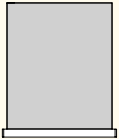

R_CG-J0103
For protection

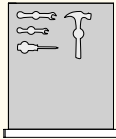

R_CG-J0203
For tools



Sold without cut-outs

Groove Trays

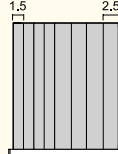

R_CG-G00803
8 groove trays
2 dividers included with each groove tray.

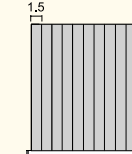

R_CG-G01003
10 groove trays

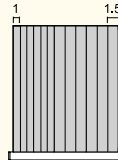

R_CG-G01203
12 groove trays

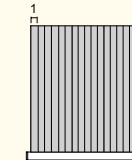

R_CG-G01603
16 groove trays

Folder Hanging Bars

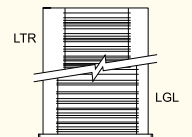

R_CG-KFB12

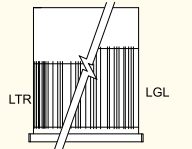

R_CG-KLR12

30" x 18" (W x D) Drawers

For Shelving

Partitions and Dividers

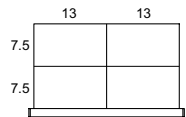

R_DC-A0102
4 compartments

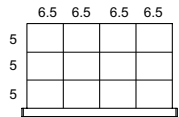

R_DC-A0308
12 compartments

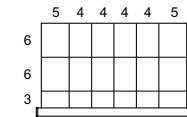

R_DC-A0512
18 compartments

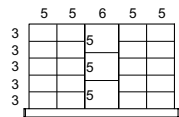

R_DC-A0418
23 compartments

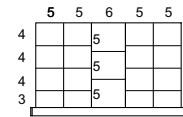

R_DC-A0414
19 compartments

Groove Trays

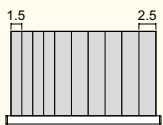

R_DC-G01003
10 groove trays

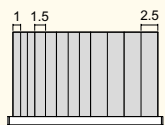

R_DC-G01203
12 groove trays

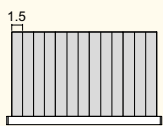

R_DC-G01303
13 groove trays

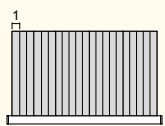

R_DC-G02103
21 groove trays

2 dividers included with each groove tray.

Foam



R_DC-J0103
For protection

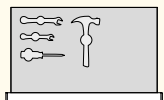

R_DC-J0203
For tools



Sold without cut-outs

Folder Hanging Bars



R_DC-KLR12



R_DC-KFB12

Plastic Bins

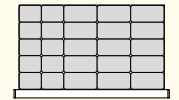

R_DC-E025
25 bins

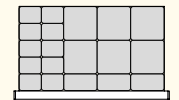

R_DC-E019
19 bins

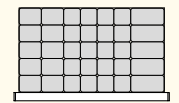

R_DC-E035
35 bins

Proposals

30" x 27" (W x D) Drawers

For Cabinet

For Multi-Drawer

Partitions and Dividers

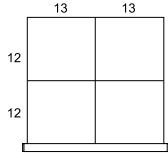

R_DG-A0102
4 compartments

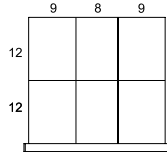

R_DG-A0203
6 compartments

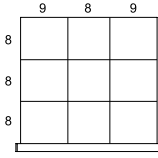

R_DG-A0206
9 compartments

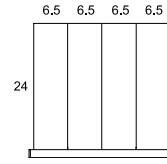

R_DG-A0300
4 compartments

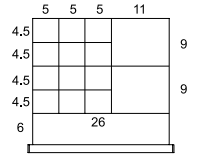

R_DG-C0410
15 compartments

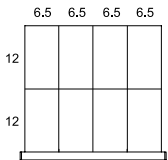

R_DG-A0304
8 compartments

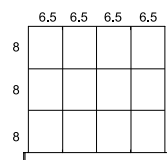

R_DG-A0308
12 compartments

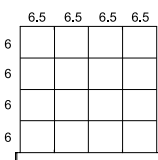

R_DG-A0312
16 compartments

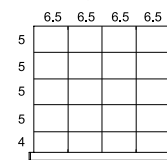

R_DG-A0316
20 compartments

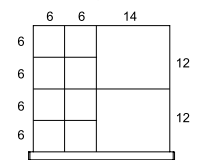

R_DG-D0207
10 compartments

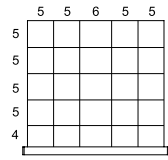

R_DG-A0420
25 compartments

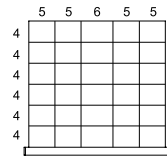

R_DG-A0425
30 compartments

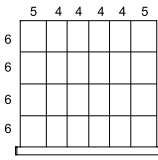

R_DG-A0518
24 compartments

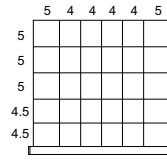

R_DG-A0524
30 compartments

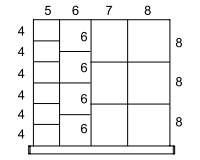

R_DG-D0312
16 compartments

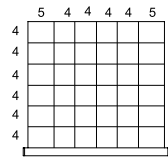

R_DG-A0530
36 compartments

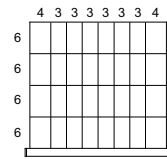

R_DG-A0724
32 compartments

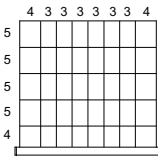

R_DG-A0732
40 compartments

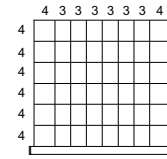

R_DG-A0740
48 compartments

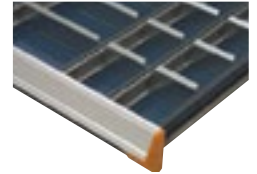

Plastic Bins

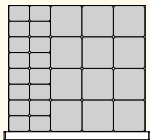

R_DG-E028
28 bins

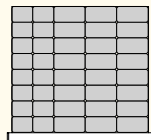

R_DG-E040
40 bins

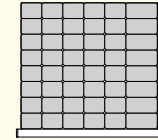

R_DG-E048
48 bins

Foam

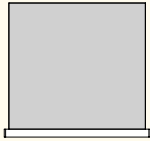

R_DG-J0103
For protection

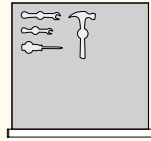

R_DG-J0203
For tools

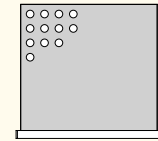

R_DG-J0303
For collets

Folder Hanging Bars

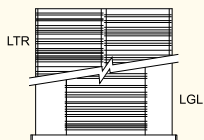

R_DG-KFB12

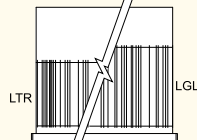

R_DG-KLR12

Sold without cut-outs

Groove Trays

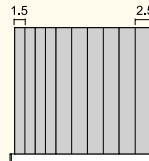

R_DG-G01003
10 groove trays

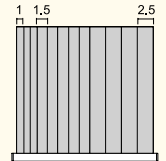

R_DG-G01203
12 groove trays

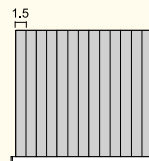

R_DG-G01303
13 groove trays

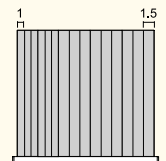

R_DG-G01503
15 groove trays

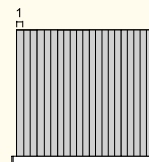

R_DG-G02103
21 groove trays

2 dividers included with each groove tray.

36" x 18" (W x D) Drawers

For Cabinet

For Shelving

Partitions and Dividers

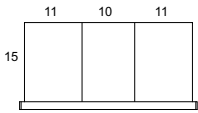

R_EC-A0200
3 compartments

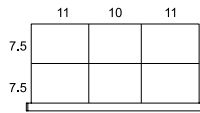

R_EC-A0203
6 compartments

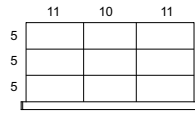

R_EC-A0206
9 compartments

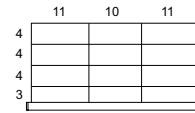

R_EC-A0209
12 compartments

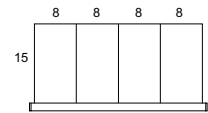

R_EC-A0300
4 compartments

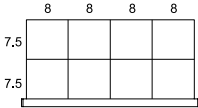

R_EC-A0304
8 compartments

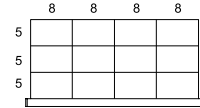

R_EC-A0308
12 compartments

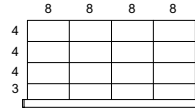

R_EC-A0312
16 compartments

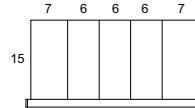

R_EC-A0400
5 compartments

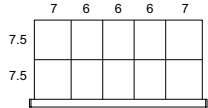

R_EC-A0405
10 compartments

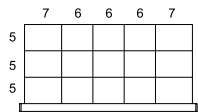

R_EC-A0410
15 compartments

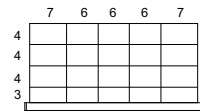

R_EC-A0415
20 compartments

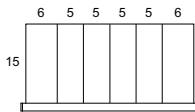

R_EC-A0500
6 compartments

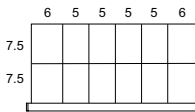

R_EC-A0506
12 compartments

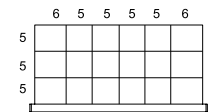

R_EC-A0512
18 compartments

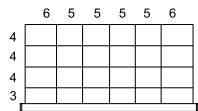

R_EC-A0518
24 compartments

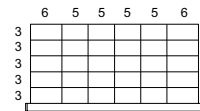

R_EC-A0524
30 compartments

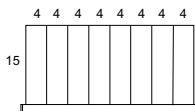

R_EC-A0700
8 compartments

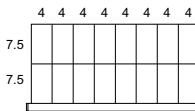

R_EC-A0708
16 compartments

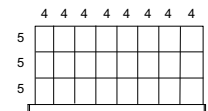

R_EC-A0716
24 compartments

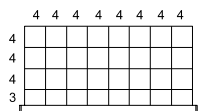

R_EC-A0724
32 compartments

Plastic Bins

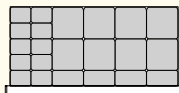

R_EC-E022
22 bins

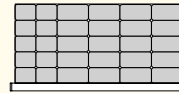

R_EC-E030
30 bins

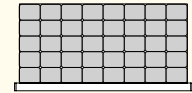

R_EC-E040
40 bins

Groove Trays

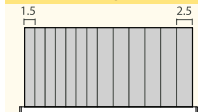

R_EC-G01303
13 groove trays

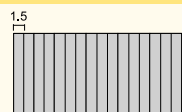

R_EC-G01603
16 groove trays

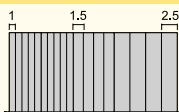

R_EC-G01803
18 groove trays

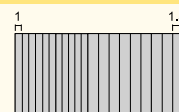

R_EC-G02003
20 groove trays



R_EC-G02603
26 groove trays

2 dividers included with each groove tray.

Foam

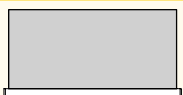

R_EC-J0103
For protection



R_EC-J0203
For tools

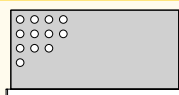

R_EC-J0303
For collets

Folder Hanging Bars

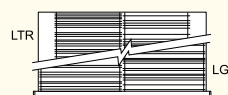

R_EC-KFB12



R_EC-KLR12



Sold without cut-outs

Proposals

36" x 24" (W x D) Drawers

For Cabinet

For Shelving

For Multi-Drawer

Partitions and Dividers

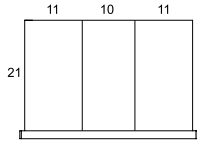

R_EE-A0200
3 compartments

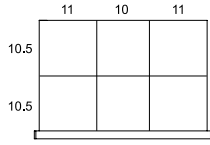

R_EE-A0203
6 compartments

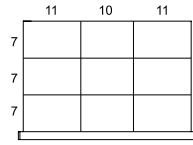

R_EE-A0206
9 compartments

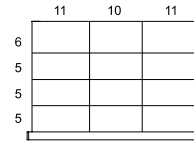

R_EE-A0209
12 compartments

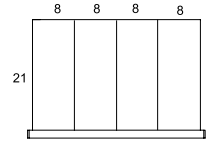

R_EE-A0300
4 compartments

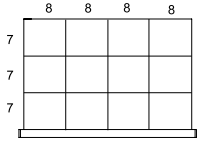

R_EE-A0308
12 compartments

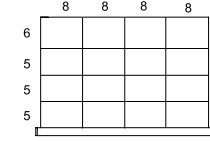

R_EE-A0312
16 compartments

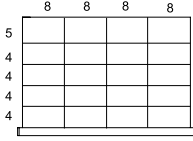

R_EE-A0316
20 compartments

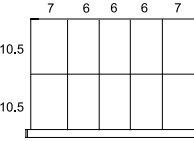

R_EE-A0405
10 compartments

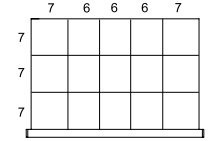

R_EE-A0410
15 compartments

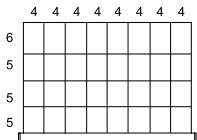

R_EE-A0724
32 compartments

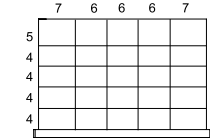

R_EE-A0420
25 compartments

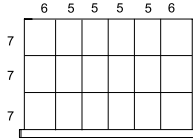

R_EE-A0512
18 compartments

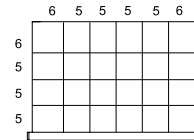

R_EE-A0518
24 compartments

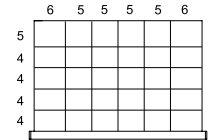

R_EE-A0524
30 compartments

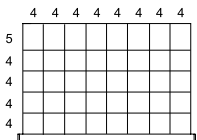

R_EE-A0732
40 compartments

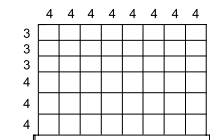

R_EE-A0740
48 compartments

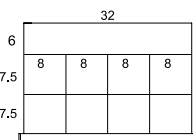

R_EE-C0404
9 compartments

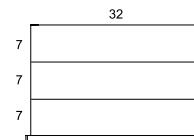

R_EE-B0200
3 compartments

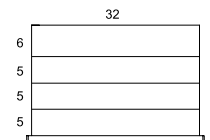

R_EE-B0300
4 compartments

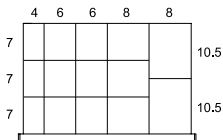

R_EE-D0409
14 compartments

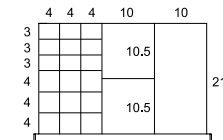

R_EE-D0416
21 compartments

Plastic Bins

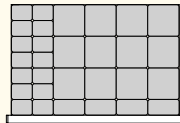

R_EE-E030
30 bins

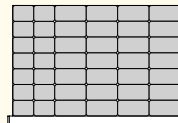

R_EE-E042
42 bins

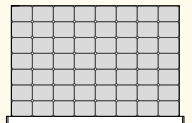

R_EE-E056
56 bins

Groove Trays

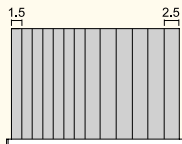

R_EE-G01303
13 groove trays

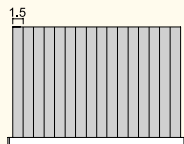

R_EE-G01603
16 groove trays

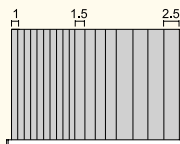

R_EE-G01803
18 groove trays

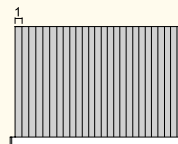

R_EE-G02603
26 groove trays

2 dividers included with each groove tray.

Foam



R_EE-J0103
For protection

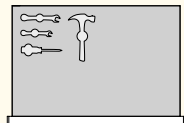

R_EE-J0203
For tools

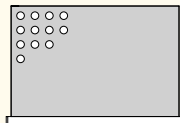

R_EE-J0303
For collets

Folder Hanging Bars

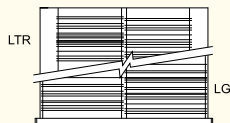

R_EE-KFB12



R_EE-KLR12

Sold without cut-outs

36" x 27" (W x D) Drawers

For Cabinet

For Multi-Drawer

Partitions and Dividers

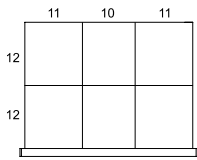

R_EG-A0203
6 compartments

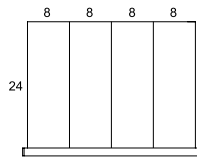

R_EG-A0300
4 compartments

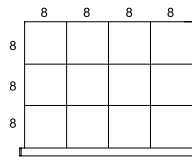

R_EG-A0308
12 compartments

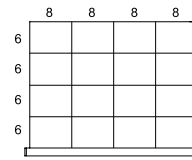

R_EG-A0312
16 compartments

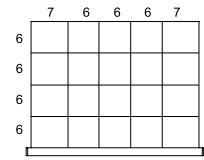

R_EG-A0415
20 compartments

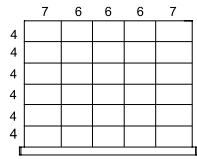

R_EG-A0425
30 compartments

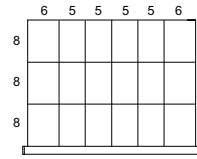

R_EG-A0512
18 compartments

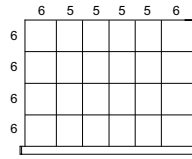

R_EG-A0518
24 compartments

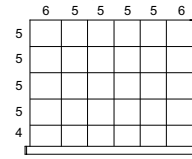

R_EG-A0524
30 compartments

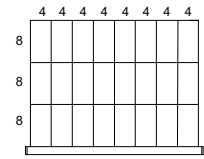

R_EG-A0716
24 compartments

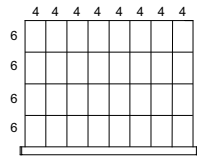

R_EG-A0724
32 compartments

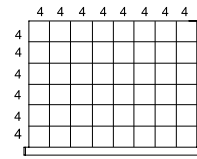

R_EG-A0740
48 compartments

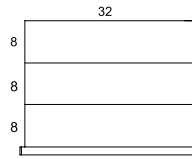

R_EG-B0200
3 compartments

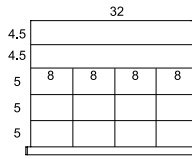

R_EG-C0508
14 compartments

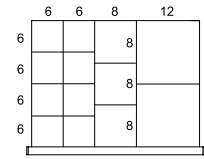

R_EG-D0309
13 compartments

Plastic Bins

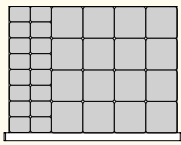

R_EG-E032
32 bins

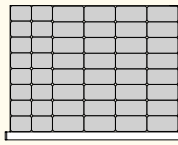

R_EG-E048
48 bins

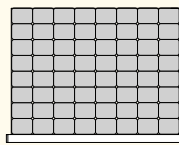

R_EG-E064
64 bins

Groove Trays

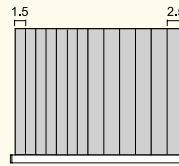

R_EG-G01303
13 groove trays

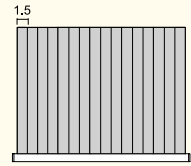

R_EG-G01603
16 groove trays

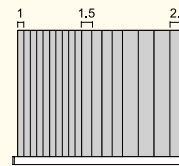

R_EG-G01803
18 groove trays

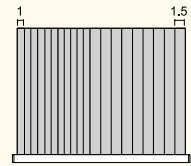

R_EG-G02003
20 groove trays

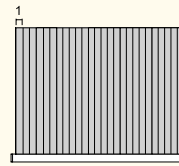

R_EG-G02603
26 groove trays

2 dividers included with each groove tray.

Foam



R_EG-J0103
For protection

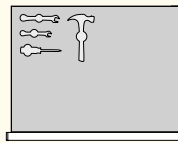

R_EG-J0203
For tools

Sold without cut-outs

Folder Hanging Bars

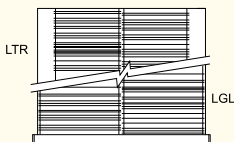

R_EG-KFB12

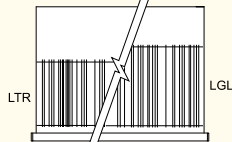

R_EG-KLR12

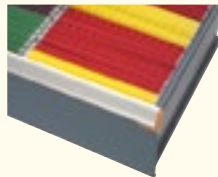

Proposals

42" x 18" (W x D) Drawers **For Shelving**

Partitions and Dividers

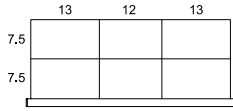

R_GC-A0203
6 compartments

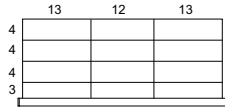

R_GC-A0209
12 compartments

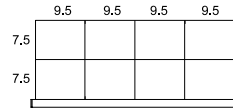

R_GC-A0304
8 compartments

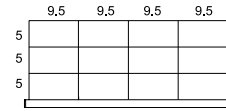

R_GC-A0308
12 compartments

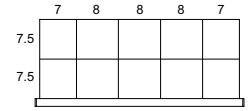

R_GC-A0405
10 compartments

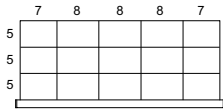

R_GC-A0410
15 compartments

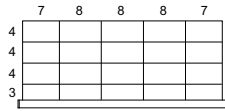

R_GC-A0415
20 compartments

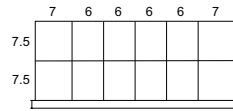

R_GC-A0506
12 compartments

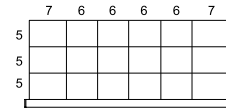

R_GC-A0512
18 compartments

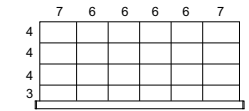

R_GC-A0518
24 compartments

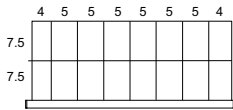

R_GC-A0708
16 compartments

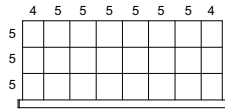

R_GC-A0716
24 compartments

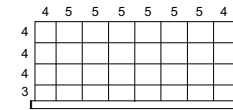

R_GC-A0724
32 compartments

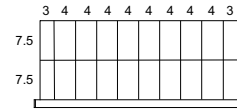

R_GC-A0910
20 compartments

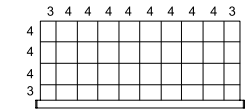

R_GC-A0930
40 compartments

Plastic Bins

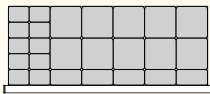

R_GC-E025
25 bins

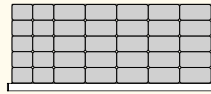

R_GC-E035
35 bins

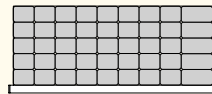

R_GC-E045
45 bins

Groove Trays

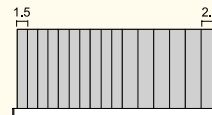

R_GC-G01603
16 groove trays

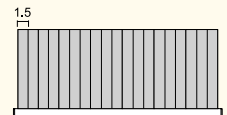

R_GC-G01903
19 groove trays

Foam



R_GC-J0103
For protection

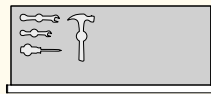

R_GC-J0203
For tools

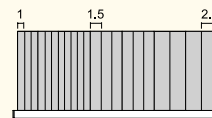

R_GC-G02103
21 groove trays

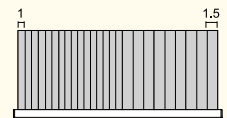

R_GC-G02503
25 groove trays

Folder Hanging Bars

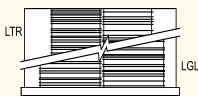

R_GC-KFB12

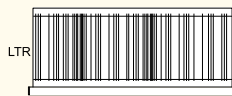

R_GC-KLR12

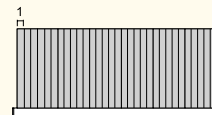

R_GC-G03103
31 groove trays

2 dividers included with each groove tray.



42" x 24" (W x D) Drawers

For Shelving

Partitions and Dividers

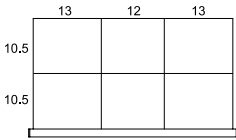

R_GE-A0203
6 compartments

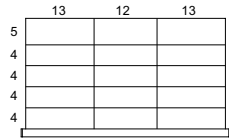

R_GE-A0212
15 compartments

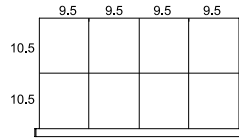

R_GE-A0304
8 compartments

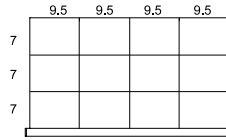

R_GE-A0308
12 compartments

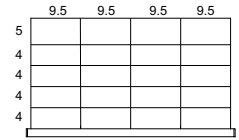

R_GE-A0316
20 compartments

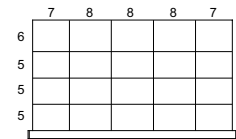

R_GE-A0415
20 compartments

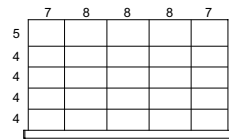

R_GE-A0420
25 compartments

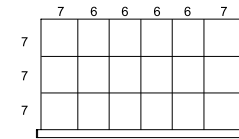

R_GE-A0512
18 compartments

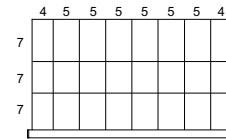

R_GE-A0716
24 compartments

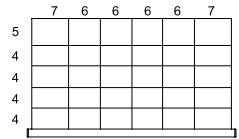

R_GE-A0524
30 compartments

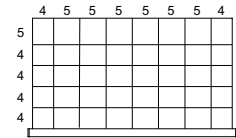

R_GE-A0732
40 compartments

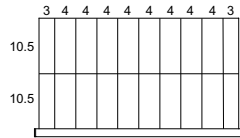

R_GE-A0910
20 compartments

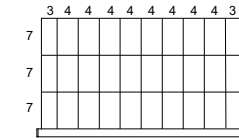

R_GE-A0920
30 compartments

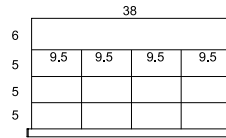

R_GE-C0408
13 compartments

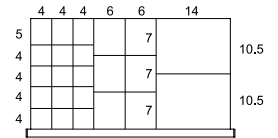

R_GE-D0517
23 compartments

Plastic Bins

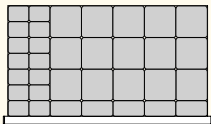

R_GE-E034
34 bins

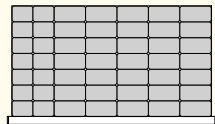

R_GE-E049
49 bins

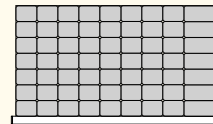

R_GE-E063
63 bins

Groove Trays

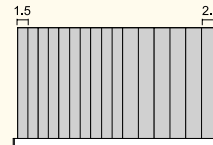

R_GE-G01603
16 groove trays

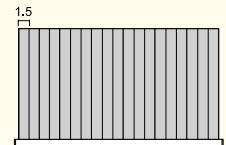

R_GE-G01903
19 groove trays

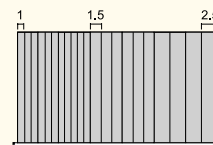

R_GE-G02103
21 groove trays

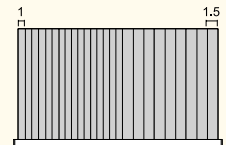

R_GE-G02503
25 groove trays

Foam



R_GE-J0103
For protection

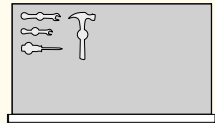

R_GE-J0203
For tools

Sold without cut-outs

Folder Hanging Bars

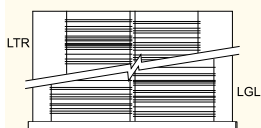

R_GE-KFB12

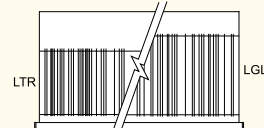

R_GE-KLR12

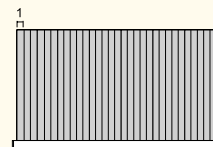

R_GE-G03103
31 groove trays

2 dividers included with each groove tray.



Proposals

48" x 18" (W x D) Drawers *For Shelving*

Partitions and Dividers

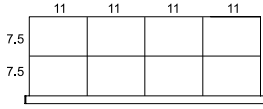

R_HC-A0304
8 compartments

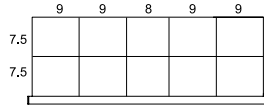

R_HC-A0405
10 compartments

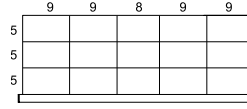

R_HC-A0410
15 compartments

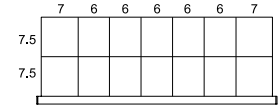

R_HC-A0607
14 compartments

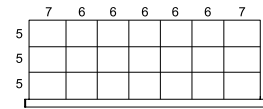

R_HC-A0614
21 compartments

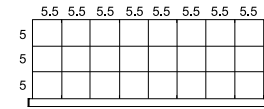

R_HC-A0716
24 compartments

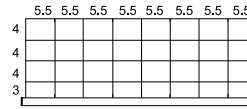

R_HC-A0724
32 compartments

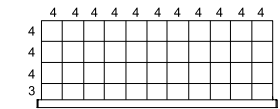

R_HC-A1033
44 compartments

Plastic Bins

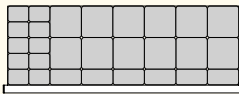

R_HC-E028
28 bins

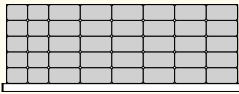

R_HC-E040
40 bins

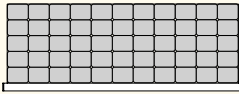

R_HC-E055
55 bins

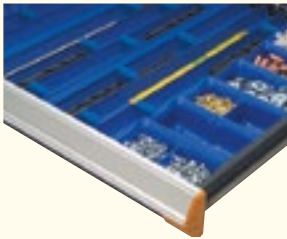

Foam



R_HC-J0103
For protection

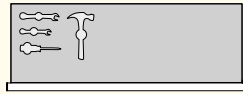

R_HC-J0203
For tools



Groove Trays

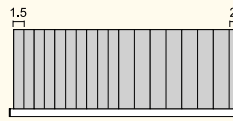

R_HC-G01803
18 groove trays

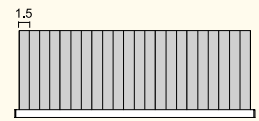

R_HC-G02203
22 groove trays

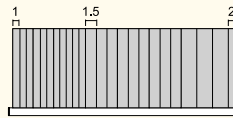

R_HC-G02403
24 groove trays

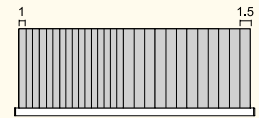

R_HC-G02803
28 groove trays

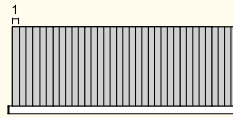

R_HC-G03603
36 groove trays

2 dividers included with each groove tray.

Folder Hanging Bars

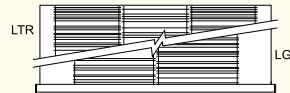

R_HC-KFB12



R_HC-KLR12

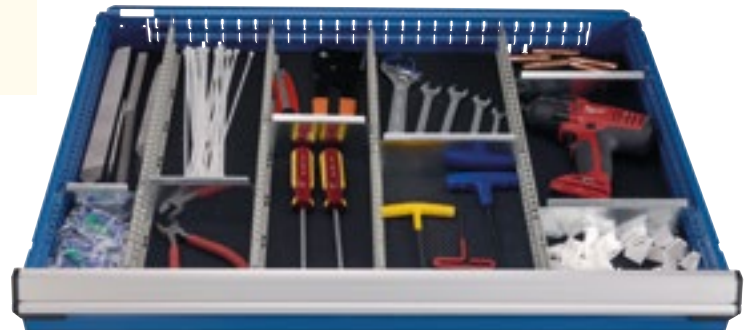

48" x 24" (W x D) Drawers

For Cabinet

For Shelving

For Multi-Drawer

Partitions and Dividers

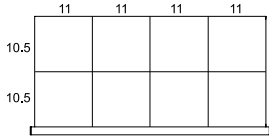

R_HE-A0304
8 compartments

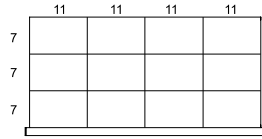

R_HE-A0308
12 compartments

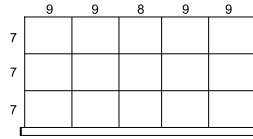

R_HE-A0410
15 compartments

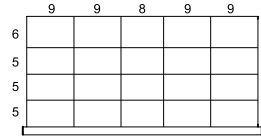

R_HE-A0415
20 compartments

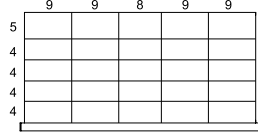

R_HE-A0420
25 compartments

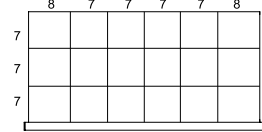

R_HE-A0512
18 compartments

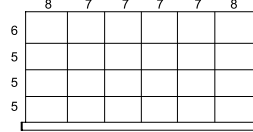

R_HE-A0518
24 compartments

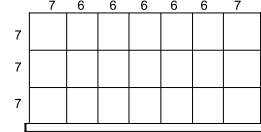

R_HE-A0614
21 compartments

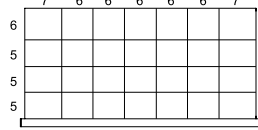

R_HE-A0621
28 compartments

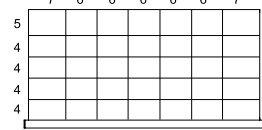

R_HE-A0628
35 compartments

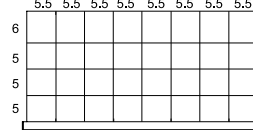

R_HE-A0724
32 compartments

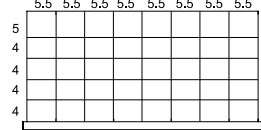

R_HE-A0732
40 compartments

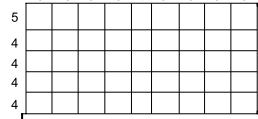

R_HE-A0836
45 compartments

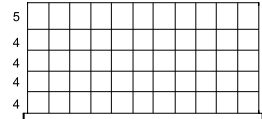

R_HE-A1044
55 compartments

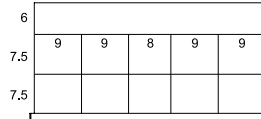

R_HE-C0505
11 compartments

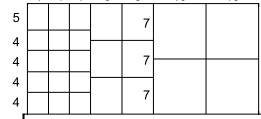

R_HE-D0618
25 compartments

Plastic Bins

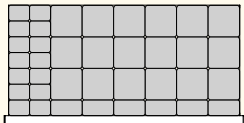

R_HE-E038
38 bins

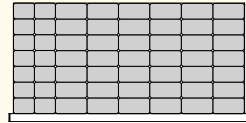

R_HE-E056
56 bins

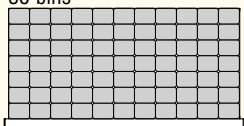

R_HE-E077
77 bins

Groove Trays

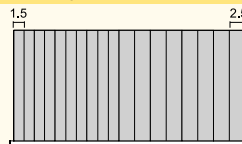

R_HE-G01803
18 groove trays

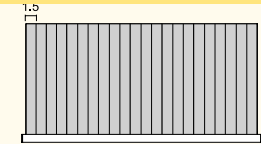

R_HE-G02203
22 groove trays

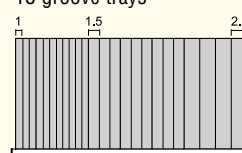

R_HE-G02403
24 groove trays

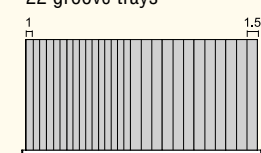

R_HE-G02803
28 groove trays

Folder Hanging Bars

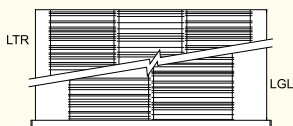

R_HE-KFB12

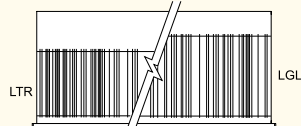

R_HE-KLR12

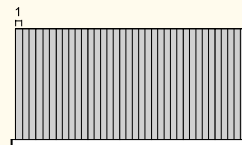

R_HE-G03603
36 groove trays

2 dividers included with each groove tray.

Foam

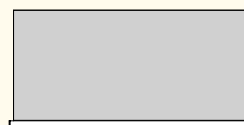

R_HE-J0103
For protection

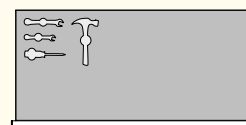

R_HE-J0203
For tools

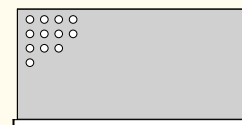

R_HE-J0303
For collets



Sold without cut-outs



Proposals

48" x 27" (W x D) Drawers For Cabinet For Multi-Drawer

Partitions and Dividers

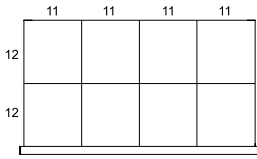

R_HG-A0304
8 compartments

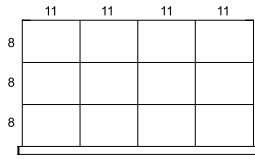

R_HG-A0308
12 compartments

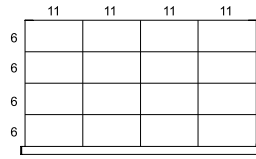

R_HG-A0312
16 compartments

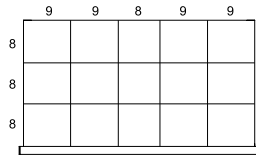

R_HG-A0410
15 compartments

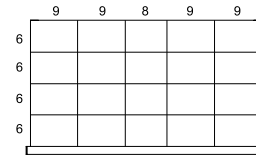

R_HG-A0415
20 compartments

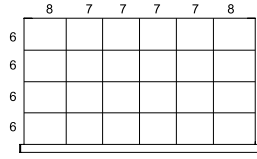

R_HG-A0518
24 compartments

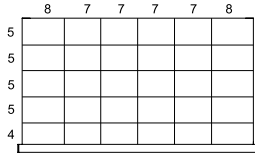

R_HG-A0524
30 compartments

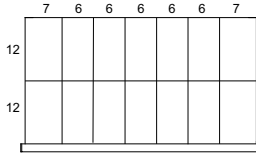

R_HG-A0607
14 compartments

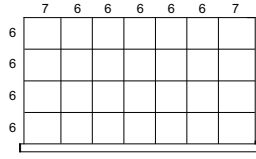

R_HG-A0621
28 compartments

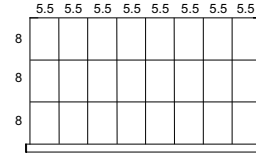

R_HG-A0716
24 compartments

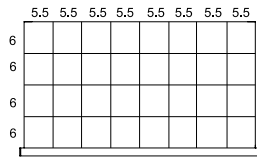

R_HG-A0724
32 compartments

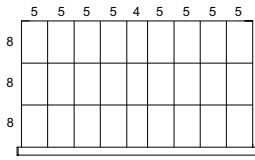

R_HG-A0818
27 compartments

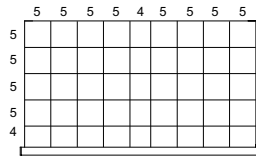

R_HG-A0836
45 compartments

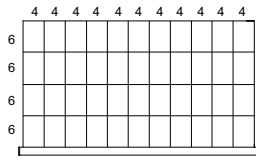

R_HG-A1033
44 compartments

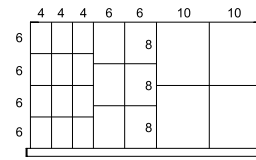

R_HG-D0615
22 compartments

Plastic Bins

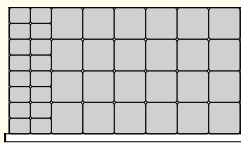

R_HG-E040
40 bins

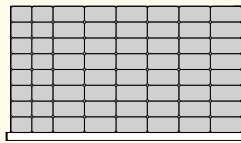

R_HG-E064
64 bins

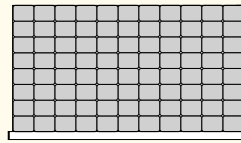

R_HG-E088
88 bins

Groove Trays

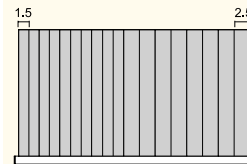

R_HG-G01803
18 groove trays

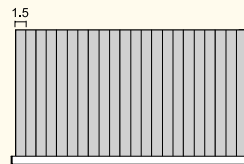

R_HG-G02203
22 groove trays

Foam



R_HG-J0103
For protection

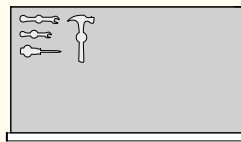

R_HG-J0203
For tools

Sold without cut-outs

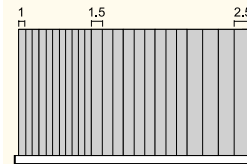

R_HG-G02403
24 groove trays

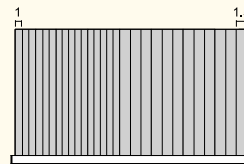

R_HG-G02803
28 groove trays

Folder Hanging Bars

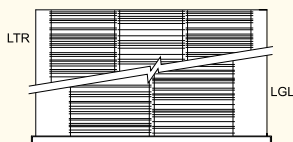

R_HG-KFB12

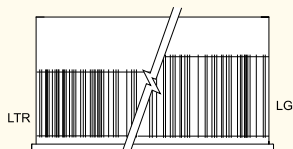

R_HG-KLR12

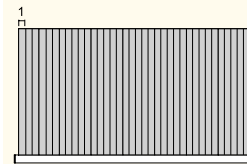

R_HG-G03603
36 groove trays

2 dividers included with each groove tray.

54" x 24" (W x D) Drawers *For Cabinet* *For Multi-Drawer*

Partitions and Dividers

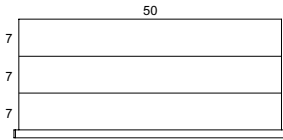

R_JE-B0200
3 compartments

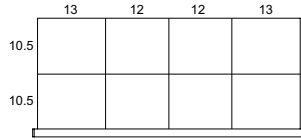

R_JE-A0304
8 compartments

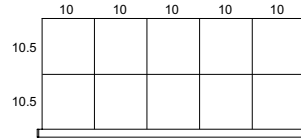

R_JE-A0405
10 compartments

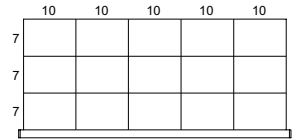

R_JE-A0410
15 compartments

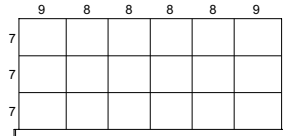

R_JE-A0512
18 compartments

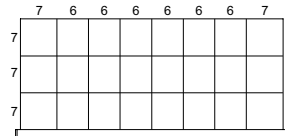

R_JE-A0716
24 compartments

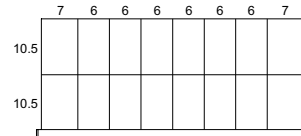

R_JE-A0708
16 compartments

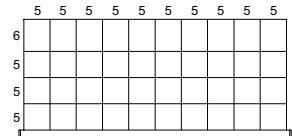

R_JE-A0930
40 compartments

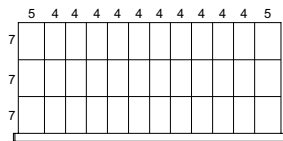

R_JE-A1124
36 compartments

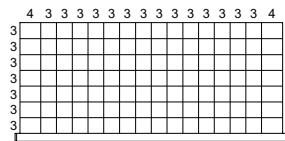

R_JE-A1596
112 compartments

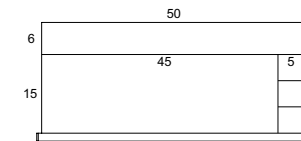

R_JE-C0202
5 compartments

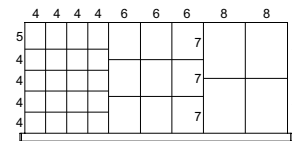

R_JE-D0824
33 compartments

Plastic Bins

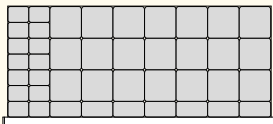

R_JE-E042
42 bins

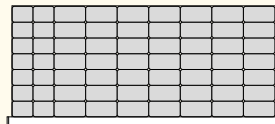

R_JE-E063
63 bins

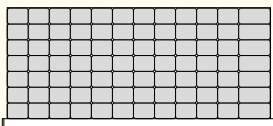

R_JE-E084
84 bins

Groove Trays

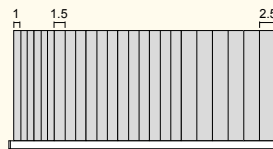

R_JE-G02403
24 groove trays

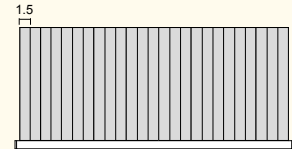

R_JE-G02503
25 groove trays

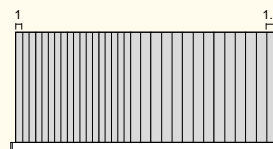

R_JE-G03203
32 groove trays

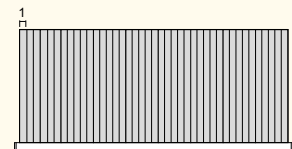

R_JE-G04103
41 groove trays

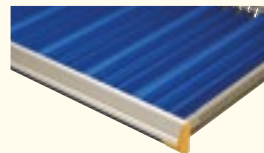

2 dividers included with each groove tray.

Foam

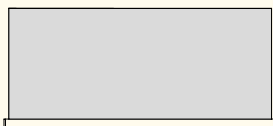

R_JE-J0103
For protection

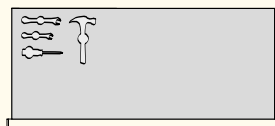

R_JE-J0203
For tools

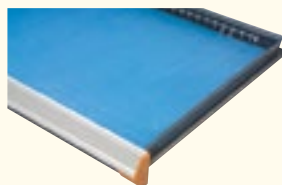

Sold without cut-outs

Folder Hanging Bars

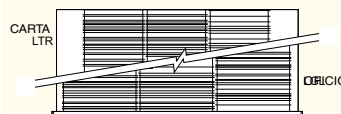

R_JE-KFB12

Proposals

54" x 27" (W x D) Drawers

For Cabinet

For Multi-Drawer

Partitions and Dividers

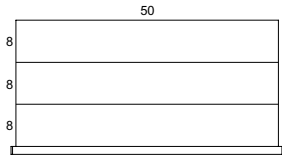

R_JG-B0200
3 compartments

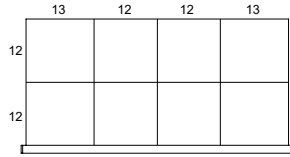

R_JG-A0304
8 compartments

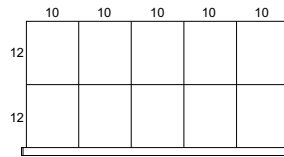

R_JG-A0405
10 compartments

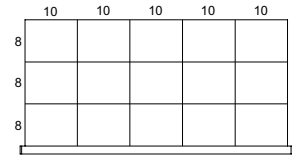

R_JG-A0410
15 compartments

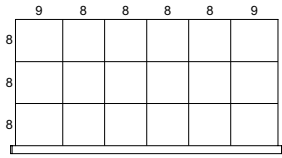

R_JG-A0512
18 compartments

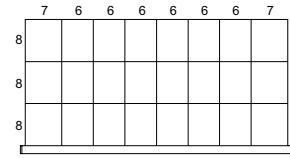

R_JG-A0716
24 compartments

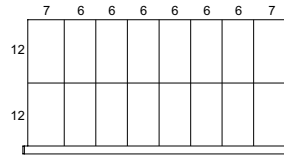

R_JG-A0708
16 compartments

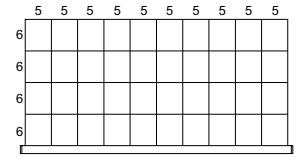

R_JG-A0930
40 compartments

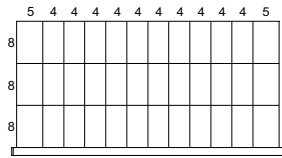

R_JG-A1124
36 compartments

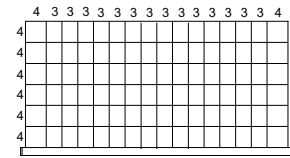

R_JG-A1580
96 compartments

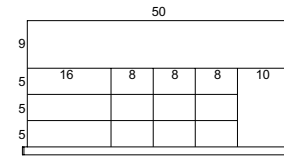

R_JG-C0508
14 compartments

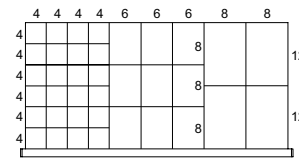

R_JG-D0828
37 compartments

Plastic Bins

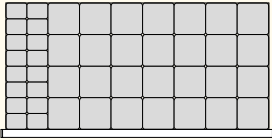

R_JG-E044
44 bins

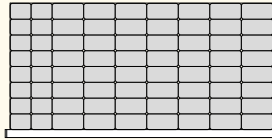

R_JG-E072
72 bins

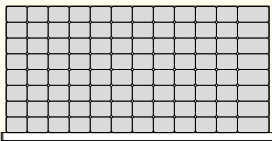

R_JG-E096
96 bins

Groove Trays

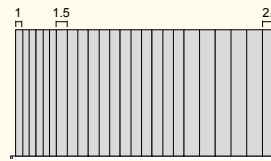

R_JG-G02403
24 groove trays

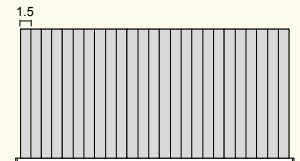

R_JG-G02503
25 groove trays

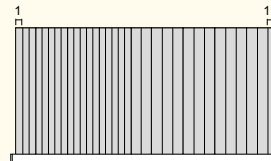

R_JG-G03203
32 groove trays

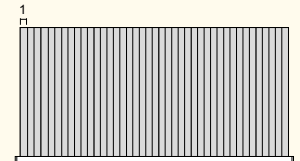

R_JG-G04103
41 groove trays

2 dividers included
with each groove tray.

Foam



R_JG-J0103
For protection

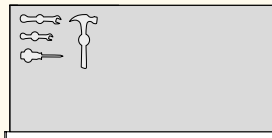

R_JG-J0203
For tools

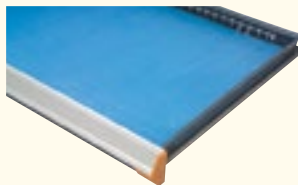

Sold without cut-outs

Folder Hanging Bars

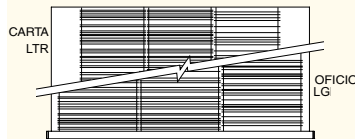

R_JG-KFB12

60" x 24" (W x D) Drawers For Cabinet For Multi-Drawer

Partitions and Dividers

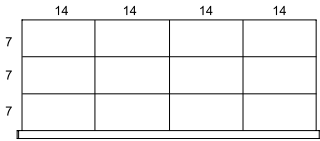

R_KE-A0308
12 compartments

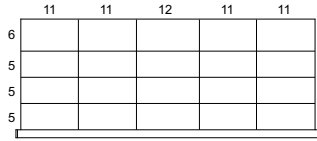

R_KE-A0415
20 compartments

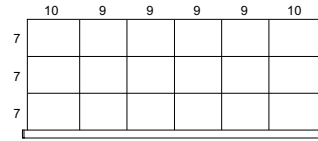

R_KE-A0512
18 compartments

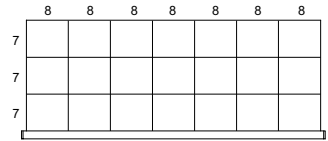

R_KE-A0614
21 compartments

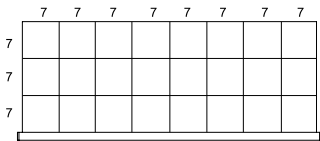

R_KE-A0716
24 compartments

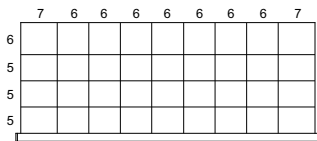

R_KE-A0827
36 compartments

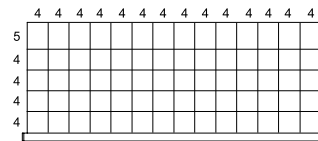

R_KE-A1356
70 compartments

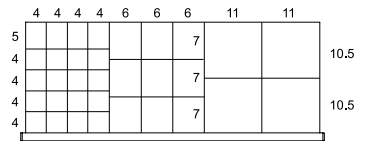

R_KE-D0824
33 compartments

Plastic Bins

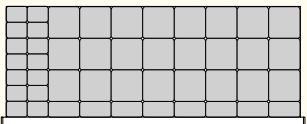

R_KE-E046
46 bins

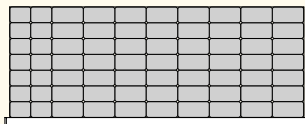

R_KE-E070
70 bins

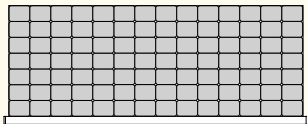

R_KE-E098
98 bins

Foam



R_KE-J0103
For protection

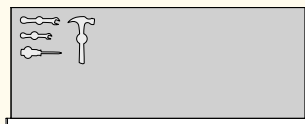

R_KE-J0203
For tools

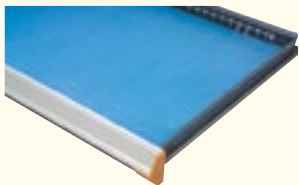

Sold without cut-outs

Groove Trays

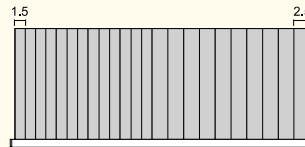

R_KE-G02303
23 groove trays

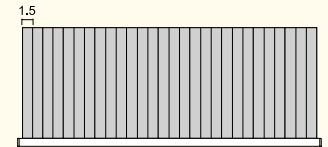

R_KE-G02803
28 groove trays

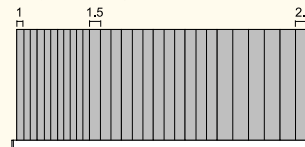

R_KE-G02903
29 groove trays

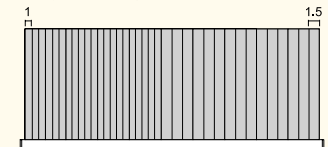

R_KE-G03603
36 groove trays

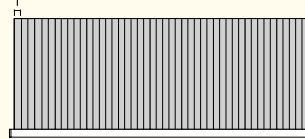

R_KE-G04603
46 groove trays

2 dividers included with each groove tray.

Folder Hanging Bars

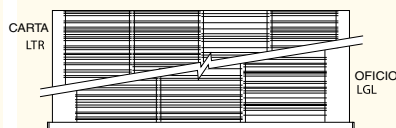

R_KE-KFB12



Proposals

60" x 27" (W x D) Drawers For Cabinet For Multi-Drawer

Partitions and Dividers

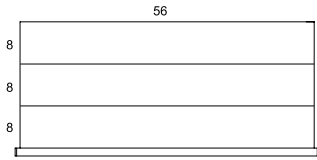

R_KG-B0200
3 compartments

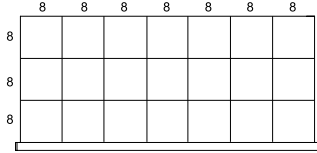

R_KG-A0614
21 compartments

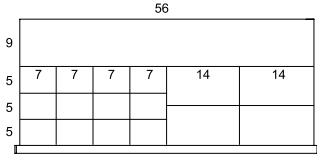

R_KG-C0610
17 compartments

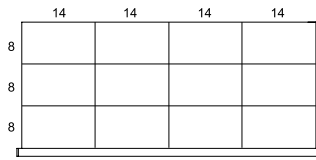

R_KG-A0308
12 compartments

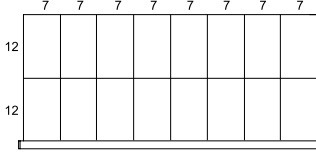

R_KG-A0708
16 compartments

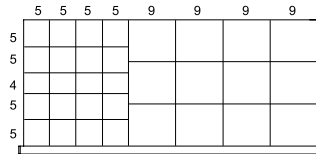

R_KG-D0724
32 compartments

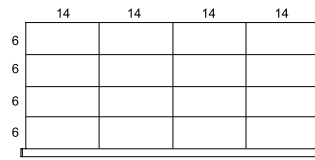

R_KG-A0312
16 compartments

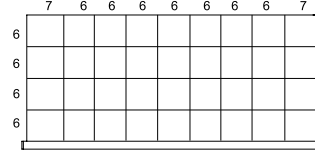

R_KG-A0827
36 compartments

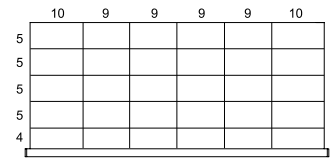

R_KG-A0524
30 compartments

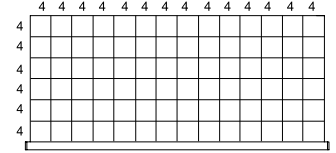

R_KG-A1370
84 compartments

Groove Trays

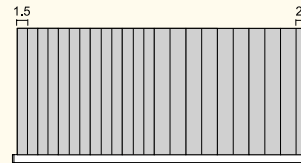

R_KG-G02303
23 groove trays

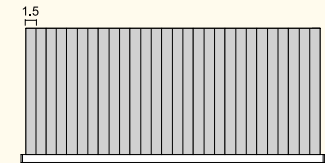

R_KG-G02803
28 groove trays

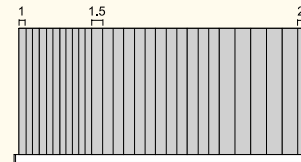

R_KG-G02903
29 groove trays

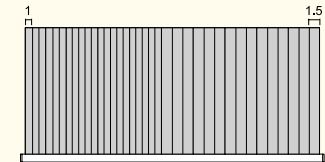

R_KG-G03603
36 groove trays

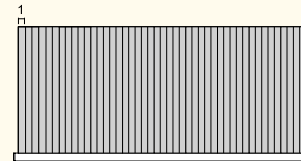

R_KG-G04603
46 groove trays

2 dividers included with each groove tray.

Plastic Bins

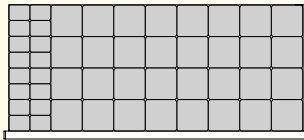

R_KG-E048
48 bins

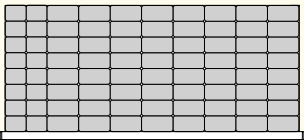

R_KG-E080
80 bins

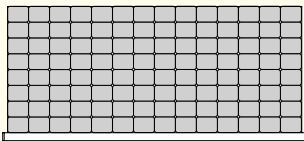

R_KG-E112
112 bins

Foam



R_KG-J0103
For protection

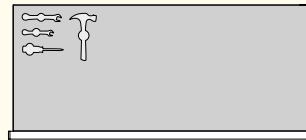

R_KG-J0203
For tools



Sold without cut-outs



Folder Hanging Bars

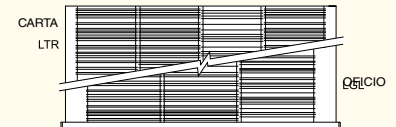

R_KG-KFB12